



SPATOILET® User's easy Manual



Time setting

Time can be set by users.

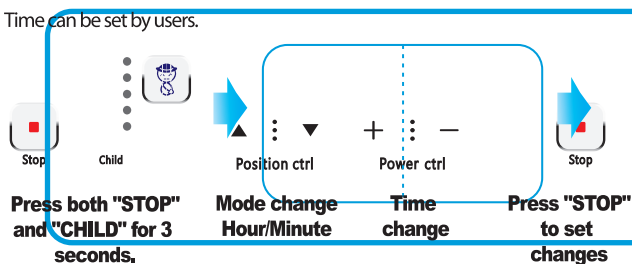

Pulse

Press "Pulse" for pulsating wash in Wash, Bidet & Enema wash. Water pressure is rhythmically changed from strong to weak.

Massage

Press "Massage" for oscillating wash in Wash and Bidet. Nozzle is moving back and forth repeatedly for massage effect. Massage will not operate in Enema wash model

Position control

Nozzle position can be changed by pressing ▲/▼ in Wash, Bidet and Enema wash.

Massage control

Massage width can be adjusted by pressing "Child" in massage mode. There are 5 levels in massage width.

Power Control

Water pressure can be adjusted by pressing + / - when using Wash, Bidet and Enema wash. Also, temperature of dryer can be adjusted by pressing + / - . There are 5 levels in each function.

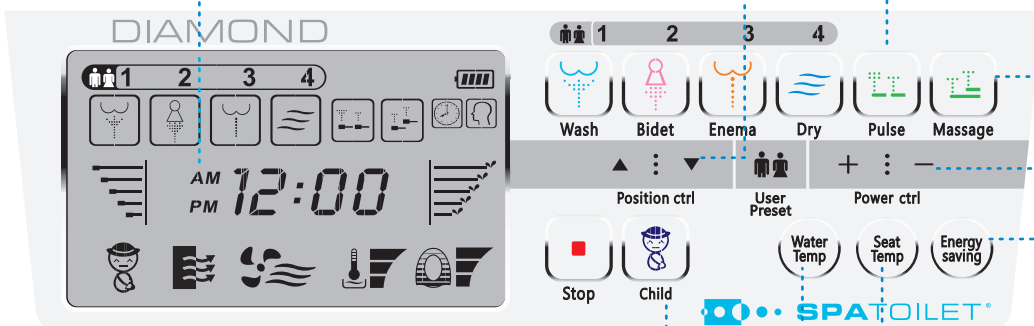

User preset

User presets and stores the memory for control setting for 4 users. For more information, please refer to the user manual.

Child

Child safety mode
Nozzle moves forward and water pressure reduced. Enema wash is not available in Child mode. Child mode will be released in 15 minutes automatically.

※ Child mode indicator icon

Water temp

Water pressure can be adjusted by 4 levels.
(Room temp / 93°F / 96°F / 100°F)
(Room temp / 34°C / 36°C / 38°C)

Seat temp

Seat temperature can be adjusted by 4 levels.
(Room temp / 93°F / 100°F / 107°F)
(Room temp / 34°C / 38°C / 42°C)

Energy saving

Energy saving mode can be changed by pressing the button (repeatedly).

Mode	LCD display
Automatic mode	
Learning energy saving	
Cancel	

How to use

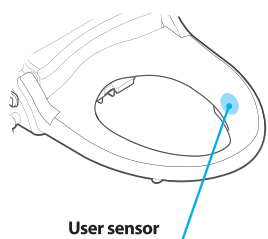

Make sure to sit on the user sensor of seat

Wash

Use for posterior wash. It runs for 2 minutes.

Enema wash

Use for enema wash. It runs for 2 minutes.

Bidet

Use for feminine wash. It runs for 2 minutes.

Dry

Use for drying your wet parts. It runs for 3 minutes.

Stop

Use to stop any operations.

※ Unless stop button is pressed, Wash/Bidet/Enema wash stops its operation in 2 minutes and dry in 3 minutes automatically.

※ There are basic function buttons (Stop/Wash/Bidet) on the right side of main unit.
If a remote control is out of order or batteries are run down, use side control buttons.
※ Press "STOP" on the side control panel to turn off the unit.